

ACCOMMODATIONS SYMBOL LEGEND

- ▶ King Bed does not convert to Twin Beds
- ★ 2 Twin Beds (convert to King) and Single Sofa Bed
- 2 Twin Beds (convert to King) and 1 Upper Pullman
- ⊙ King Bed (does not convert to Twin Beds) and Single Sofa Bed
- ☾ King Bed (does not convert to Twin Beds) and 1 Upper Pullman
- 2 Twin Beds (convert to King) and 2 Upper Pullmans
- 2 Twin Beds (convert to King), Single Sofa Bed and 1 Upper Pullman
- † 2 Twin Beds (convert to King) and Double Sofa Bed
- King Bed, 1 Upper Pullman and Single Sofa Bed
- ◆ Stateroom with 2 Porthole Windows
- ◁ Connecting staterooms (ideal for families and groups of friends)
- ✱ Twin beds do not convert to a King Bed
- U Unisex Wheelchair Accessible Restroom
- ⊗ All accommodations are non-smoking.

- 8A 8B 8C 8D Balcony Staterooms: Beds do not convert to King when both Upper Pullmans in use.

Accessible staterooms are available for guests with disabilities. Please contact Guest Access Services at 1-800-438-6744 ext. 70025 for details, or visit <http://www.carnival.com/about-carnival/special-needs.aspx>.

CATEGORIES

- 1A Interior Upper/Lower
- PT Porthole
- 4A 4B 4C 4D 4E 4I Interior
- 6A 6B 6C 6D 6E Ocean View
- 6J Scenic Ocean View
- 8A 8B 8C 8D 8E Balcony
- 8M Aft-View Extended Balcony
- 0B Junior Suite (obstructed views)
- J5 JT Junior Suite
- GS Grand Suite
- ES Extended Balcony Grand Suite
- GV Grand Vista Suite

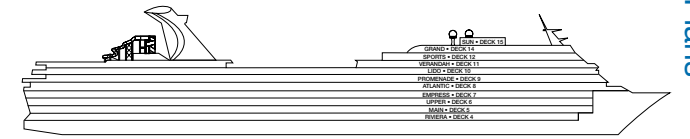

Gross Tonnage: 71,909 Length: 855 Feet Beam: 103 Feet
 Cruising Speed: 21 Knots Guest Capacity: 2,190 (Double Occupancy)
 Total Staff: 900 Registry: Panama

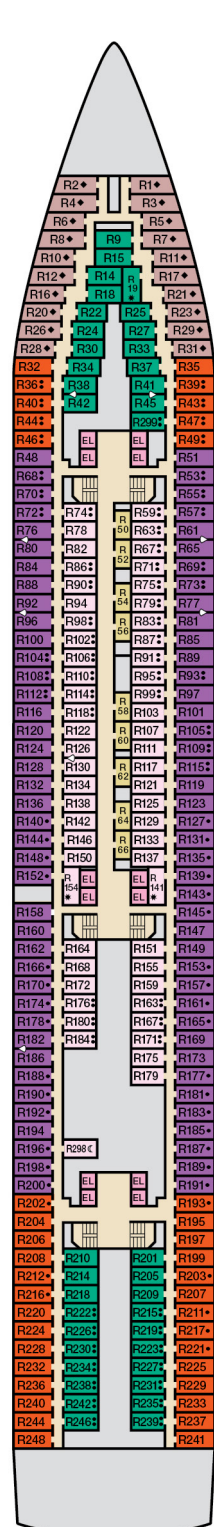

Riviera • Deck 4

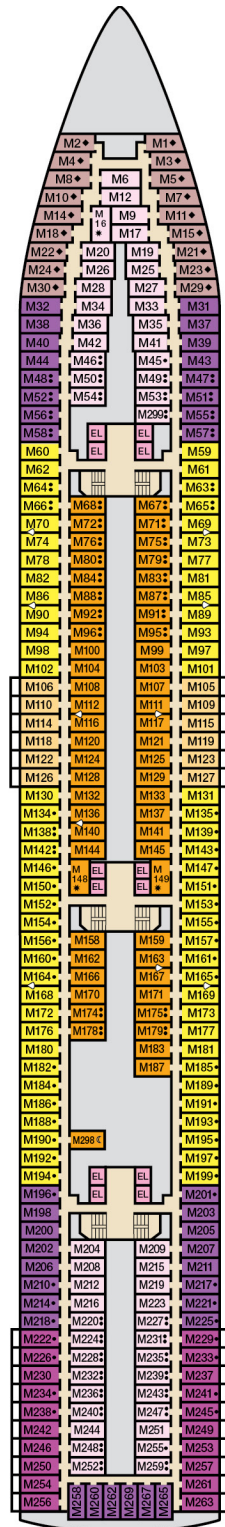

Main • Deck 5

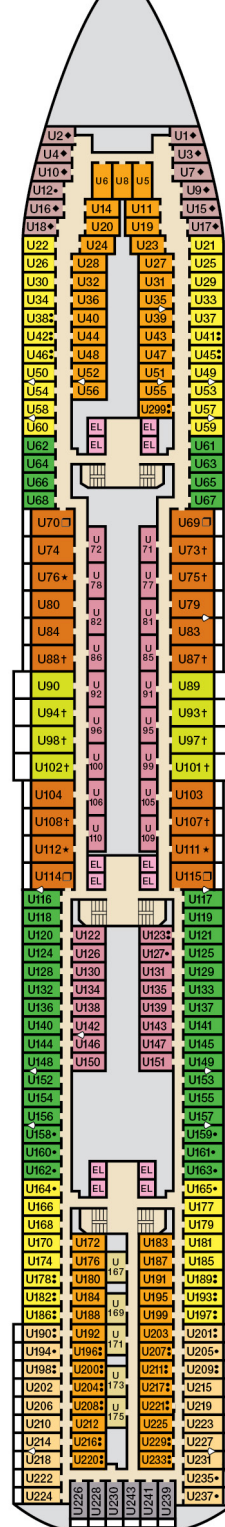

Upper • Deck 6

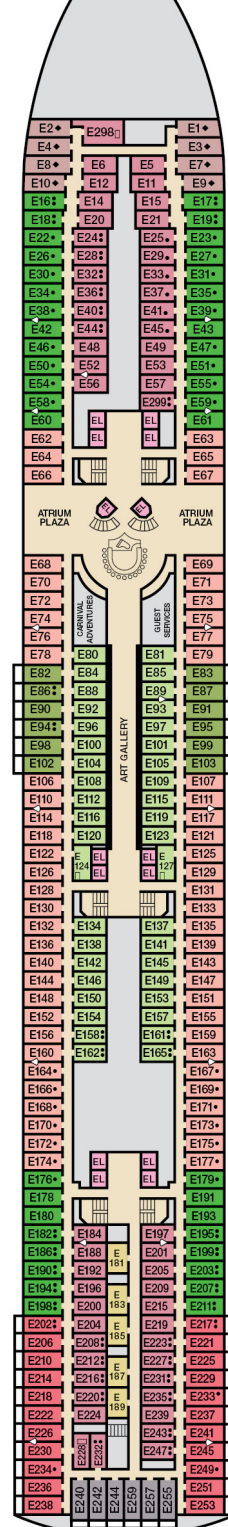

Empress • Deck 7

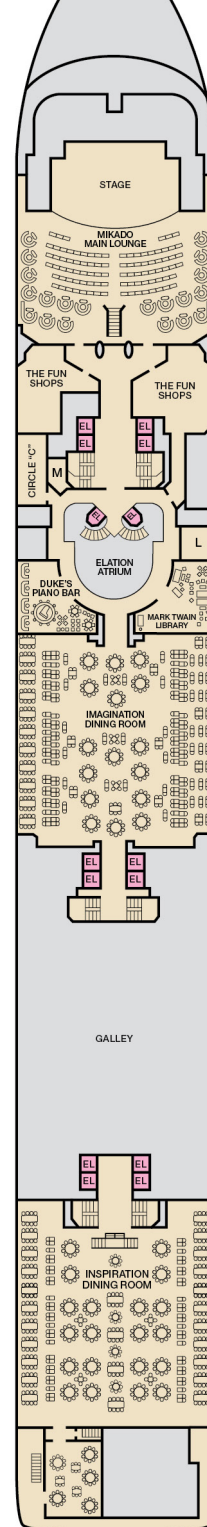

Atlantic • Deck 8

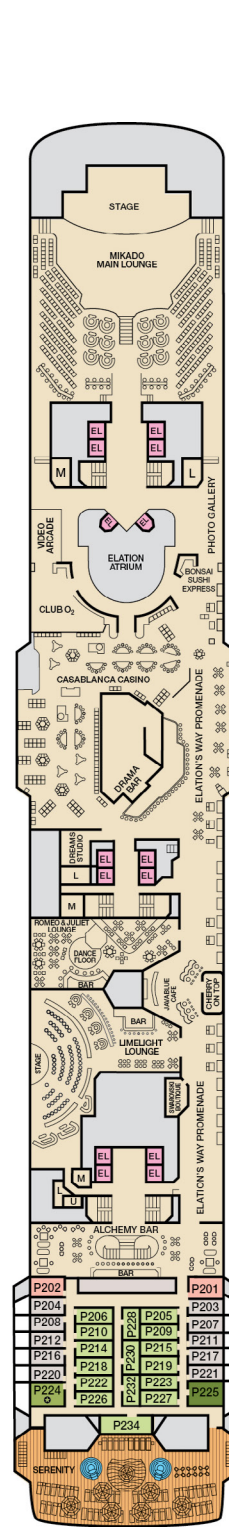

Promenade • Deck 9

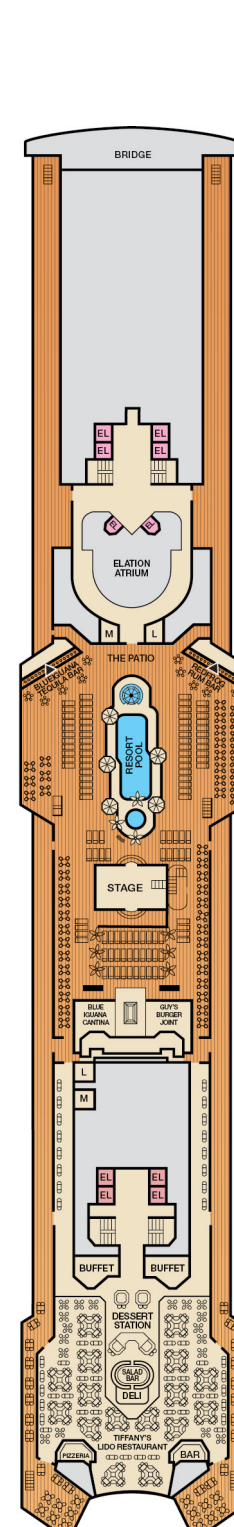

Lido • Deck 10

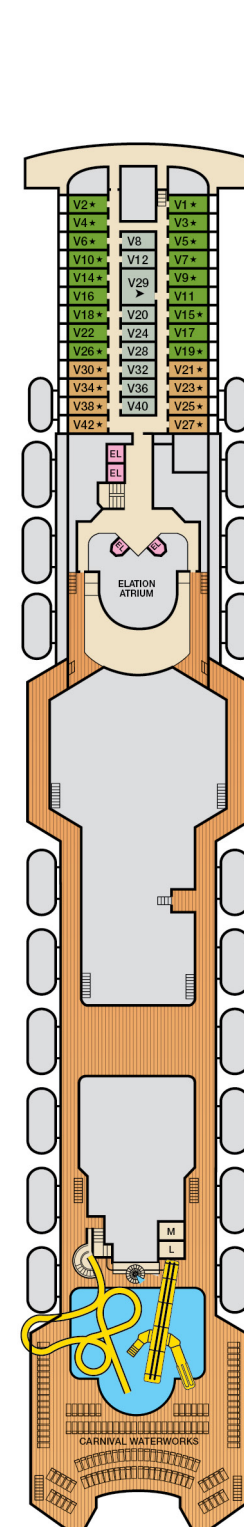

Verandah • Deck 11



Forward Sports • Deck 12

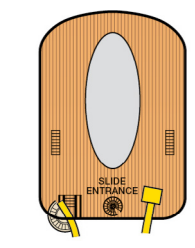

Aft Sports • Deck 12

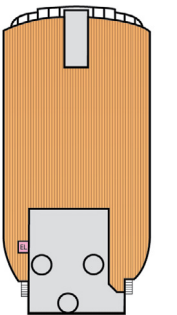

Sun • Deck 15

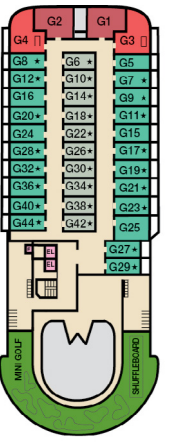

Grand • Deck 15

ACCOMMODATIONS SYMBOL LEGEND

- ▶ King Bed does not convert to Twin Beds
 - ★ 2 Twin Beds (convert to King) and Single Sofa Bed
 - 2 Twin Beds (convert to King) and 1 Upper Pullman
 - ⊗ King Bed (does not convert to Twin Beds) and Single Sofa Bed
 - ⊕ King Bed (does not convert to Twin Beds) and 1 Upper Pullman
 - ⊖ 2 Twin Beds (convert to King) and 2 Upper Pullmans
 - 2 Twin Beds (convert to King), Single Sofa Bed and 1 Upper Pullman
 - † 2 Twin Beds (convert to King) and Double Sofa Bed
- King Bed, 1 Upper Pullman and Single Sofa Bed
 - ◆ Stateroom with 2 Porthole Windows
 - ◊ Connecting staterooms (ideal for families and groups of friends)
 - ✱ Twin beds do not convert to a King Bed
 - U Unisex Wheelchair Accessible Restroom
 - ⊗ All accommodations are non-smoking.

- Accessible Routes including Ramps
- Restrooms, Elevators, Lifts and other Accessible Areas
- Fully Accessible Staterooms (FAC)
- Fully Accessible Staterooms - Single Side Approach (FAC-SSA)
- Ambulatory Accessible Staterooms (AAC)

Please contact Guest Access Services for specific ship accessibility features. You may also visit <http://www.carnival.com/about-carnival/special-needs.aspx>



Gross Tonnage: 71,909 Length: 855 Feet Beam: 103 Feet
 Cruising Speed: 21 Knots Guest Capacity: 2,190 (Double Occupancy)
 Total Staff: 900 Registry: Panama

